

臨時封閉大埔泰亨中心圍連接大窩西支路的路口**Temporary Closure of the Junction of Tai Hang Chung Sum Wai and Tai Wo Service Road West**

為興建中心圍的泰亨牌樓，中心圍連接大窩西支路的路口將於 2019 年 9 月 16 日至 2020 年 2 月 15 日臨時封閉。受影響的車輛須改經灰沙圍的車道前往泰亨及前清雅園藝公司旁的車道往大窩西支路。現場會設置適當的臨時交通標誌指示各道路使用者，駕駛人士請遵照現場指示，並小心駕駛。我們為此工程將造成的不便之處，謹此致歉。

有關臨時封閉道路詳情如下：

2019 年 9 月 16 日至 2020 年 2 月 15 日

To facilitate the construction of Tai Hang Pai Lau, the junction of Chung Sum Wai and Tai Wo Service Road West will be temporarily closed from 16 September 2019 to 15 February 2020. Affected vehicles will be diverted via the access road of Tai Hang Fui Sha Wai to Tai Hang and the access road adjacent to former Elegance Garden Company to Tai Wo Service Road West. Appropriate temporary traffic aids will be erected on site. Motorists are advised to follow the instructions on site and drive in utmost care. We are sorry for any inconvenience caused due to the construction works.

Please see below details the temporary road closure:

16 September 2019 to 15 February 2020

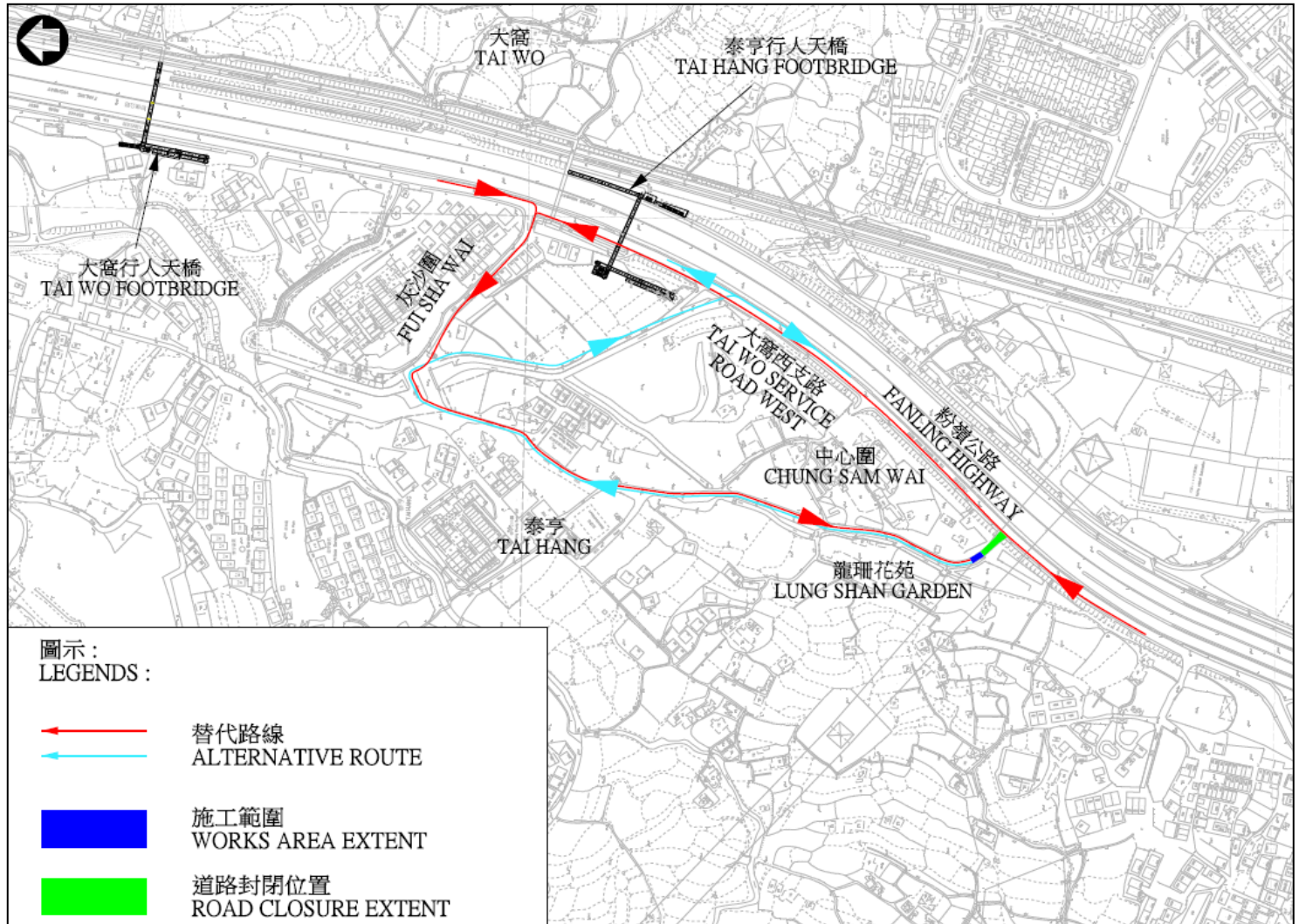

路政署將密切留意交通情況並採取必要措施，務求將交通影響減至最低。如對上述交通安排有任何查詢，請致電二十四小時熱線：8208 2230。

Highways Department will closely monitor the traffic conditions and implement any necessary measures to ensure the traffic impacts are kept to a minimum. Should you have any enquiries, please call the 24-hour hotline: 8208 2230.